

# PH ES Peripheral Pumps

The PH ES range of peripheral pumps with horizontal suction and vertical delivery are designed for continuous operation at 2.5 l/min and above, and offer a number of seal and motor options to meet your requirements.

A vertical suction range is also available (see PH TS data sheet).

## Application

The range of PH ES peripheral pumps is designed to pump clean, fresh water. Other clean, non aggressive, non explosive liquids with similar characteristics to water may be pumped.

The PH ES range can be used for pressure boosting, fluid transfer and distribution. They are suitable for flooded suction applications. Alternatively a maximum suction lift of 4.6 m is permitted when using a Stuart footvalve/strainer.

## Materials

Body	Brass
Impeller	Brass
Pump shaft	Stainless steel
Seal options	Nitrile/carbon/ceramic Nitrile/carbon/silicon Viton/carbon/silicon

## Operating Conditions

Max. liquid temp.	80°C
Min. liquid temp.	4°C
Max. suction lift	4.6 m
Max. ambient air temp.	40°C
Max. viscosity	50 Secs redwood no. 1 9.5 centistokes

## Pump Connection Sizes

Inlet	G 1 Female
Outlet	G 1 Female

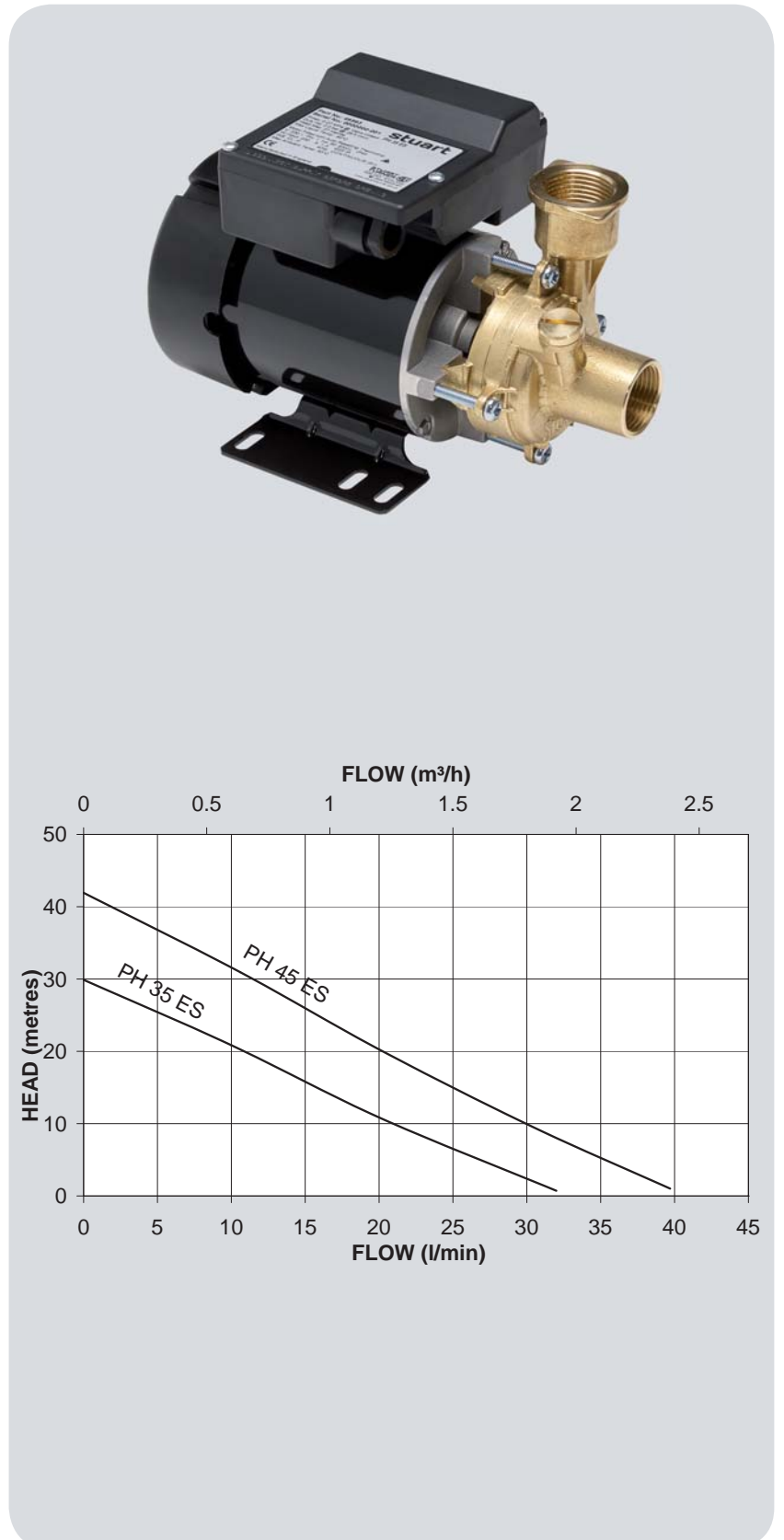

## PH ES Peripheral Pumps

Model	Motor	Nominal watts	Max. watts consumed	Amps full load	Impeller	Seal	Carton dims. mm			Gross weight (packed) kg	Part no.
							L	x W	xH		
PH 35 ES	230/1/50	120	380	1.6	Brass	Nit/Car/Cer	323	x 185	x 188	5.0	46563
	230/1/50	120	380	1.6	Brass	Nit/Car/Sil	323	x 185	x 188	5.0	46450
	230/1/50	120	380	1.6	Brass	Vit/Car/Sil	323	x 185	x 188	5.0	46451
PH 45 ES	230/1/50	300	540	2.4	Brass	Nit/Car/Cer	323	x 185	x 188	6.5	46564
	230/1/50	300	540	2.4	Brass	Nit/Car/Sil	323	x 185	x 188	6.5	46453
	230/1/50	300	540	2.4	Brass	Vit/Car/Sil	323	x 185	x 188	6.5	46454

Built to IP44, all motors are designed for continuous running @ 4.5 l/min and above and feature totally enclosed fan ventilated cooling and integral thermal overload protection.

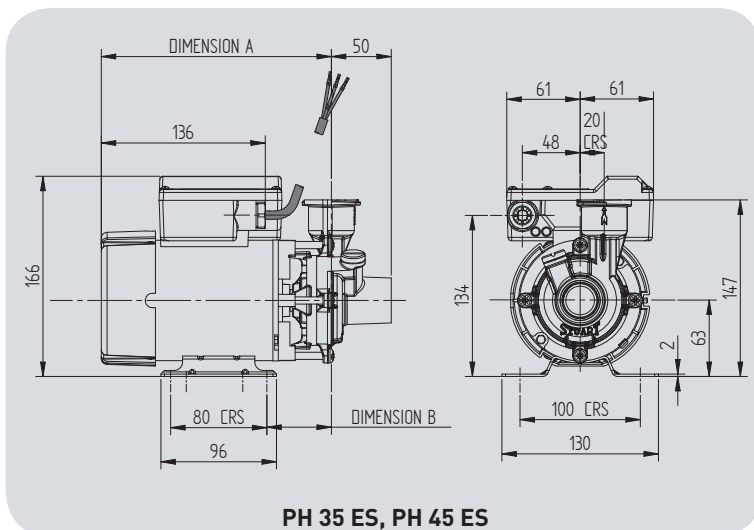

Pump Description	Dim. A	Dim. B
PH 35 ES	191	54
PH 45 ES	220	54

All dimensions shown are in mm.

Stuart Turner Ltd  
Henley-on-Thames  
Oxfordshire RG9 2AD  
England

Telephone: +44 (0)1491 572655  
Fax: +44 (0)1491 573704

info@stpumps.co.uk  
www.stuart-turner.co.uk

V.A.T. REG. No. 199 0987 92.  
Registered in England No. 88368.  
Registered Office:  
Market Place, Henley-on-Thames

